

KALKITE ST

SUBSTATION

EXISTING PUBLIC TOILETS

EXISTING FOOTPATH

EXISTING FOOTPATH

EXISTING GARDEN BED

EXISTING DRIVEWAY

NEW FOOTPATH

NEW PEDESTRIAN BARRIER & RETAINING WALL

NEW KERB & GUTTER

SNOWY RIVER AVE

EXISTING ISLAND REMOVED

NEW RECONFIGURED KERB ALIGNMENT

NEW FLUSH STREET THRESHOLD TREATMENT

NEW SW PIT

NEW SW PIT

NEW RAISED PEDESTRIAN CROSSING

NEW SW PIT

NEW DISH DRAIN

NEW SW PIT

NEW DISH DRAIN

EXISTING ISLAND REMOVED

EXISTING LIGHT REMOVED

NEW KERB & GUTTER

RETAINING WALL AND HANDRAIL

RETAINING WALL AND HANDRAIL

RAMP

CENTRAL PARK TERRACE

1
300

CENTRAL PARK SHOPS

POTENTIAL IMPROVEMENTS BY PRIVATE PROPERTY OWNERS. OPPORTUNITY TO CREATE OUTDOOR DINING AREA

NEW RECONFIGURED KERB ALIGNMENT

EXISTING LIGHT

RAISED DISABILITY PARKING AREA

SEAT

SEAT

SEAT

NEW DRIVEWAY ENTRANCE TO KALKITE STREET CARPARK

KALKITE STREET CARPARK (REFER TO OPTIONS)

LEGEND

GENERAL

- LEGAL PROPERTY BOUNDARY
- BUILDING FACADE
- OVERHEAD AWNING
- EXISTING STREET LIGHT POLE
- EXISTING LIGHT IN PRIVATE PROPERTY
- PROPOSED NEW LIGHT POLE
- - - EXISTING KERB REMOVED

KERBS, PAVING AND ROAD PAVEMENTS

- EXISTING KERB TO BE RETAINED
- NEW CONCRETE KERB AND GUTTER
- NEW ROAD SURFACING
- NEW FOOTPATH PAVING ADBRI BI-PAVE - SHOTBLASH FINISH COLOUR - FOSSIL REFER TO PAVING PALETTE LD-SK-400
- NEW FOOTPATH PAVING ADBRI BI-PAVE - SHOTBLASH FINISH COLOUR - NATURAL REFER TO PAVING PALETTE LD-SK-400
- NEW TACTILE INDICATORS REFER TO PAVING PALETTE LD-SK-400
- NEW STREET THRESHOLD TREATMENT REFER TO PAVING PALETTE LD-SK-400

FURNITURE

- NEW WALL EXTENSION
- NEW SEAT WITH BACK REST REFER TO STREET FURNITURE PALETTE LD-SK-40
- NEW BICYCLE RACKS REFER TO STREET FURNITURE PALETTE LD-SK-401
- NEW LITTER BINS REFER TO STREET FURNITURE PALETTE LD-SK-401
- NEW BOLLARD REFER TO STREET FURNITURE PALETTE LD-SK-401

SOFTWORKS

- EXISTING TREE TO BE RETAINED
- EXISTING TREE TO BE REMOVED
- PROPOSED FEATURE TREE REFER TO PLANTING PALETTE LD-SK-402
- PROPOSED NEW STREET TREE PLANTING REFER TO PLANTING PALETTE LD-SK-402
- NEW GARDEN BEDS AND PLANTING REFER TO STREET FURNITURE PALETTE LD-SK-402
- EXISTING GARDEN BED/ TURF



CONCEPT PLAN - STREETScape DETAIL SHEET 1

SNOWY RIVER AVENUE PRECINCT - CONCEPT DESIGN

REFER TO DWG 02150559-LD-SK-201

LEGEND

GENERAL

- LEGAL PROPERTY BOUNDARY
- BUILDING FACADE
- - - OVERHEAD AWNING
- EXISTING STREET LIGHT POLE
- EXISTING LIGHT IN PRIVATE PROPERTY
- PROPOSED NEW LIGHT POLE
- - - EXISTING KERB REMOVED

KERBS, PAVING AND ROAD PAVEMENTS

- EXISTING KERB TO BE RETAINED
- NEW CONCRETE KERB AND GUTTER
- NEW ROAD SURFACING
- NEW FOOTPATH PAVING ADBRI BI-PAVE - SHOTBLASH FINISH COLOUR - FOSSIL REFER TO PAVING PALETTE LD-SK-400
- NEW FOOTPATH PAVING ADBRI BI-PAVE - SHOTBLASH FINISH COLOUR - NATURAL REFER TO PAVING PALETTE LD-SK-400
- NEW TACTILE INDICATORS REFER TO PAVING PALETTE LD-SK-400
- NEW STREET THRESHOLD TREATMENT REFER TO PAVING PALETTE LD-SK-400

FURNITURE

- NEW WALL EXTENSION
- WALL NEW FEATURE STONE WALL
- SEAT NEW SEAT WITH BACK REST REFER TO STREET FURNITURE PALETTE LD-SK-40
- BR NEW BICYCLE RACKS REFER TO STREET FURNITURE PALETTE LD-SK-401
- BIN NEW LITTER BINS REFER TO STREET FURNITURE PALETTE LD-SK-401
- B NEW BOLLARD REFER TO STREET FURNITURE PALETTE LD-SK-401

SOFTWORKS

- EXISTING TREE TO BE RETAINED
- EXISTING TREE TO BE REMOVED
- PROPOSED FEATURE TREE REFER TO PLANTING PALETTE LD-SK-402
- PROPOSED NEW STREET TREE PLANTING REFER TO PLANTING PALETTE LD-SK-402
- NEW GARDEN BEDS AND PLANTING REFER TO PLANTING PALETTE LD-SK-402
- EXISTING GARDEN BED/ TURF

NUGGETS CROSSING SHOPPING CENTRE CARPARK



REFER TO DWG 02150559-LD-SK-201



CONCEPT PLAN - STREETScape DETAIL SHEET 3

SNOWY RIVER AVENUE PRECINCT - CONCEPT DESIGN

REFER TO DWG 02150559-LD-SK-204

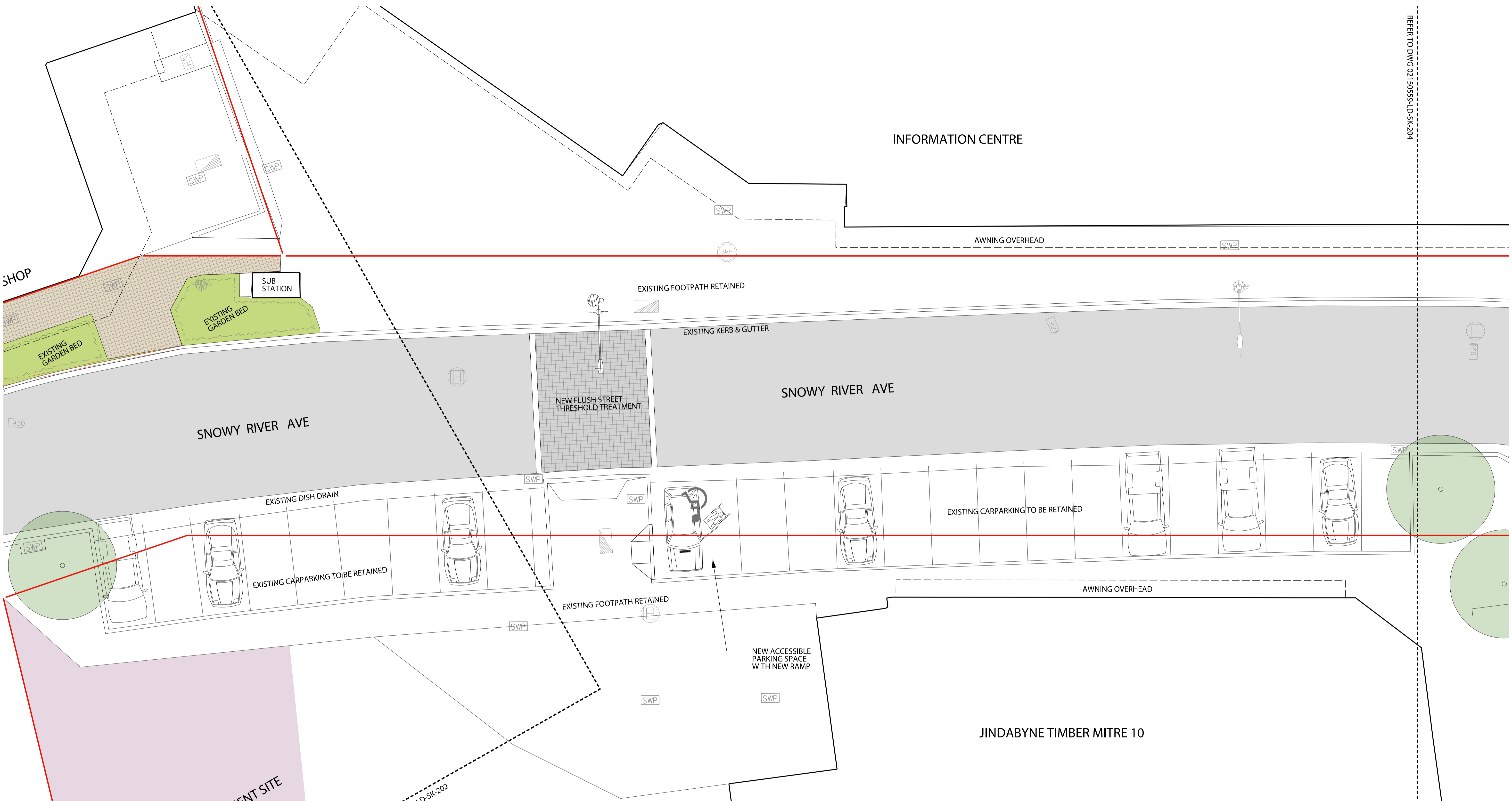

LEGEND		GENERAL	
	LEGAL PROPERTY BOUNDARY		EXISTING KERB TO BE RETAINED
	BUILDING FACADE		NEW CONCRETE KERB AND GUTTER
	OVERHEAD AWNING		NEW ROAD SURFACING
	EXISTING STREET LIGHT POLE		NEW FOOTPATH PAVING ADBRI BI-PAVE - SHOTBLASH FINISH COLOUR - FOSSIL REFER TO PAVING PALETTE LD-SK-400
	EXISTING LIGHT IN PRIVATE PROPERTY		NEW FOOTPATH PAVING ADBRI BI-PAVE - SHOTBLASH FINISH COLOUR - NATURAL REFER TO PAVING PALETTE LD-SK-400
	PROPOSED NEW LIGHT POLE		NEW TACTILE INDICATORS REFER TO PAVING PALETTE LD-SK-400
	EXISTING KERB REMOVED		NEW STREET THRESHOLD TREATMENT REFER TO PAVING PALETTE LD-SK-400
	NEW WALL EXTENSION		NEW BICYCLE RACKS REFER TO STREET FURNITURE PALETTE LD-SK-401
	NEW FEATURE STONE WALL		NEW LITTER BINS REFER TO STREET FURNITURE PALETTE LD-SK-401
	NEW SEAT WITH BACK REST REFER TO STREET FURNITURE PALETTE LD-SK-40		NEW BOLLARD REFER TO STREET FURNITURE PALETTE LD-SK-401
	NEW BICYCLE RACKS REFER TO STREET FURNITURE PALETTE LD-SK-401		
	NEW LITTER BINS REFER TO STREET FURNITURE PALETTE LD-SK-401		
	NEW BOLLARD REFER TO STREET FURNITURE PALETTE LD-SK-401		
	EXISTING TREE TO BE RETAINED		
	EXISTING TREE TO BE REMOVED		
	PROPOSED FEATURE TREE REFER TO PLANTING PALETTE LD-SK-402		
	PROPOSED NEW STREET TREE PLANTING REFER TO PLANTING PALETTE LD-SK-402		
	NEW GARDEN BEDS AND PLANTING REFER TO PLANTING PALETTE LD-SK-402		
	EXISTING GARDEN BED/ TURF		

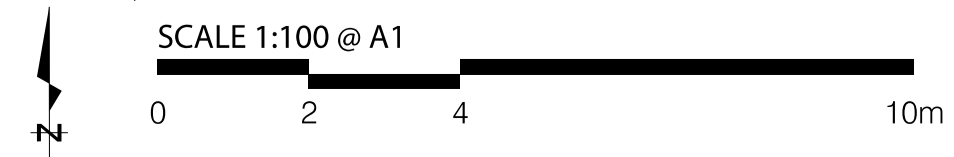

CONCEPT PLAN - STREETScape DETAIL SHEET 4
SNOWY RIVER AVENUE PRECINCT - CONCEPT DESIGN

INFORMATION CENTRE

AWNING OVERHEAD

EXISTING FOOTPATH RETAINED

SNOWY RIVER AVE

NEW FLUSH STREET THRESHOLD TREATMENT

NEW KERB & GUTTER

DRIVEWAY

NEW CONCRETE FOOTPATH

RELOCATE EXISTING WATER METER INTO PRIVATE PROPERTY

FUTURE DEVELOPMENT SITE

NEW KERB RAMP

THREDBO TERRACE

NEW KERB RAMP

EXISTING CONCRETE FOOTPATH

NEW KERB & GUTTER

LEGEND

GENERAL

- LEGAL PROPERTY BOUNDARY
- BUILDING FACADE
- - - OVERHEAD AWNING
- EXISTING STREET LIGHT POLE
- EXISTING LIGHT IN PRIVATE PROPERTY
- PROPOSED NEW LIGHT POLE
- - - EXISTING KERB REMOVED

LIGHTING

- EXISTING STREET LIGHT POLE
- EXISTING LIGHT IN PRIVATE PROPERTY
- PROPOSED NEW LIGHT POLE
- - - EXISTING KERB REMOVED

KERBS, PAVING AND ROAD PAVEMENTS

- EXISTING KERB TO BE RETAINED
- NEW CONCRETE KERB AND GUTTER
- NEW ROAD SURFACING
- NEW FOOTPATH PAVING ADBRI BI-PAVE - SHOTBLASH FINISH COLOUR - FOSSIL REFER TO PAVING PALETTE LD-SK-400
- NEW FOOTPATH PAVING ADBRI BI-PAVE - SHOTBLASH FINISH COLOUR - NATURAL REFER TO PAVING PALETTE LD-SK-400
- NEW TACTILE INDICATORS REFER TO PAVING PALETTE LD-SK-400
- NEW STREET THRESHOLD TREATMENT REFER TO PAVING PALETTE LD-SK-400

FURNITURE

- NEW WALL EXTENSION
- NEW FEATURE STONE WALL
- NEW SEAT WITH BACK REST REFER TO STREET FURNITURE PALETTE LD-SK-40
- NEW BICYCLE RACKS REFER TO STREET FURNITURE PALETTE LD-SK-401
- NEW LITTER BINS REFER TO STREET FURNITURE PALETTE LD-SK-401
- NEW BOLLARD REFER TO STREET FURNITURE PALETTE LD-SK-401

SOFTWORKS

- EXISTING TREE TO BE RETAINED
- EXISTING TREE TO BE REMOVED
- PROPOSED FEATURE TREE REFER TO PLANTING PALETTE LD-SK-402
- PROPOSED NEW STREET TREE PLANTING REFER TO PLANTING PALETTE LD-SK-402
- NEW GARDEN BEDS AND PLANTING REFER TO PLANTING PALETTE LD-SK-402
- EXISTING GARDEN BED/ TURF

REFER TO DWG 02150559-LD-SK-203

SCALE 1:100 @ A1
0 2 4 10m

CONCEPT PLAN - STREETSCAPE DETAIL SHEET 5

SNOWY RIVER AVENUE PRECINCT - CONCEPT DESIGN

LEGEND

- | | | | |
|--------------------------------------|--|----------------------|--|
| GENERAL | KERBS, PAVING AND ROAD PAVEMENTS | FURNITURE | SOFTWORKS |
| — LEGAL PROPERTY BOUNDARY | — EXISTING KERB TO BE RETAINED | — NEW WALL EXTENSION | ● EXISTING TREE TO BE RETAINED |
| — BUILDING FACADE | — NEW CONCRETE KERB AND GUTTER | — WALL | ○ EXISTING TREE TO BE REMOVED |
| — OVERHEAD AWNING | ■ NEW ROAD SURFACING | — SEAT | ● PROPOSED FEATURE TREE
REFER TO PLANTING PALETTE LD-SK-402 |
| LIGHTING | ■ NEW FOOTPATH PAVING
ADBRI BI-PAVE - SHOTBLASH FINISH
COLOUR - FOSSIL
REFER TO PAVING PALETTE LD-SK-400 | — BR | ● PROPOSED NEW STREET TREE PLANTING
REFER TO PLANTING PALETTE LD-SK-402 |
| — EXISTING STREET LIGHT POLE | ■ NEW FOOTPATH PAVING
ADBRI BI-PAVE - SHOTBLASH FINISH
COLOUR - NATURAL
REFER TO PAVING PALETTE LD-SK-400 | — BIN | ■ NEW GARDEN BEDS AND PLANTING
REFER TO PLANTING PALETTE LD-SK-402 |
| — EXISTING LIGHT IN PRIVATE PROPERTY | ■ NEW TACTILE INDICATORS
REFER TO PAVING PALETTE LD-SK-400 | ○ B | ■ EXISTING GARDEN BED/ TURF |
| — PROPOSED NEW LIGHT POLE | ■ NEW STREET THRESHOLD TREATMENT
REFER TO PAVING PALETTE LD-SK-400 | | |
| --- EXISTING KERB REMOVED | | | |



SCALE 1:100 @ A1
0 2 4 10m

CONCEPT PLAN - STREETScape DETAIL SHEET 6
SNOWY RIVER AVENUE PRECINCT - CONCEPT DESIGN