

# Snowy River Hostel

Expressions of Interest

## Project Details

<b>Project Name</b>	Snowy Monaro Regional Council – EOI Snowy River Hostel 2024	<b>Date Opened</b>	30/01/24
<b>Project Background</b>	<p>Snowy Monaro Regional Council (SMRC) was formed through the merger of three councils in 2016: Snowy River Shire Council, Cooma-Monaro Shire Council and Bombala Council.</p> <p>Council's overall resident population is now estimated at 20,997, and spread across a vast rural area of approximately 15,000 square kilometres of predominantly agricultural land used for grazing sheep and cattle. There are a number of towns and villages of varying size and population, with the three largest towns being Cooma, Jindabyne and Bombala.</p> <p>SMRC has been undertaking the divestment of residential aged care services over the last three years.</p> <p>As part of this transition, the Snowy River Hostel residential aged care facility in Berridale will soon be closed.</p> <p>SMRC is seeking expressions of interests from organisations and/or operators who can provide short-term respite care (or similar type services) to the residents of the Snowy Monaro region through the repurposing of the Snowy River Hostel facility.</p> <p>Snowy River Hostel was opened in 1993 to provide residential aged care services for residents of the wider region, with an extension in 2006 expanding the facility to 10 resident beds and one staff bed. There has been no major refurbishment after 2006.</p>		
<b>Project Scope</b>	<p><b>Location:</b> Lot 3 DP 801367 1 Jindalee Street, Berridale NSW 2628</p> <p><b>Preferred Model Type:</b> Cottage respite (Commonwealth Home Support Programme), Short-term accommodation or respite (NDIS), other respite models not listed above</p> <p><b>Other Models of Consideration:</b> Alternative care models to support people over the age of 65 years, Affordable or Community Housing, and/or Crisis Housing.</p> <p>All proposed alternative uses subject to land use permissibility.</p> <p><b>Site:</b> See Appendix 1 and 2.</p> <p><b>Infrastructure:</b> Transfer of some infrastructure may be negotiated based on the approved model.</p> <p><b>Availability:</b> To be negotiated with preferred provider.</p> <p><b>Condition:</b> Current state. No funding or available grants tied to the facility are available for any new service provider to repurpose the facility.</p> <p><b>Parking:</b> Available unmarked spaces of up to 20 vehicles.</p> <p><b>Entity Details Required:</b> Entity Name, ABN/CAN, Contact Details, Proposed Use, Proposed Commencement</p>		

## Submission Specifications

<b>EOI Submission Criteria</b>	<p>The expression of interest must include a sound business case that details:</p> <ul style="list-style-type: none"> <li>• Proposed business model</li> <li>• Evidence to support the business model and viability of service option/s presented</li> <li>• Demonstrated need (statistics preferred)</li> <li>• Existing service footprint in the region – list of services offered and locations</li> <li>• Resourcing options and evidence for the proposed model</li> <li>• Entity details; Entity name, ABN/CAN, contact details, proposed use, proposed commencement date</li> <li>• Tenure proposed for the facility</li> <li>• Any limitations on providing the service i.e. awaiting grant applications or funding sources</li> </ul>
<b>Submission Dates</b>	<p>Submissions are due by <b>9am</b> Wednesday 28 February 2024.</p> <p>Submitted electronically to: <a href="mailto:council@snowymonaro.nsw.gov.au">council@snowymonaro.nsw.gov.au</a></p> <p>All enquiries are to be directed to Bianca Padbury on 1300 345 345 or via email <a href="mailto:bianca.padbury@snowymonaro.nsw.gov.au">bianca.padbury@snowymonaro.nsw.gov.au</a></p> <p>On-site briefing is set for interested parties on Monday 12 February 2024.</p>

## Appendices

Map and satellite imagery are included for the information of interested parties.

### Appendices for Snowy Monaro Regional Council – EOI Snowy River Hostel 2024

- Appendix 1 Map data indicating site location
- Appendix 2 Satellite imagery with site location highlighted

These appendices are included on the following page.

While due care has been taken in compiling these maps, no responsibility will be taken by Snowy Monaro Regional Council for any errors or omissions. Snowy Monaro Regional Council, to the full extent permitted by law, excludes all warranties and disclaims any responsibility to any person for loss or damage suffered from any use of these maps.

Cadastral and topographic data © 2020 NSW Department of Customer Service.

**Appendix 1 Map data indicating site location**

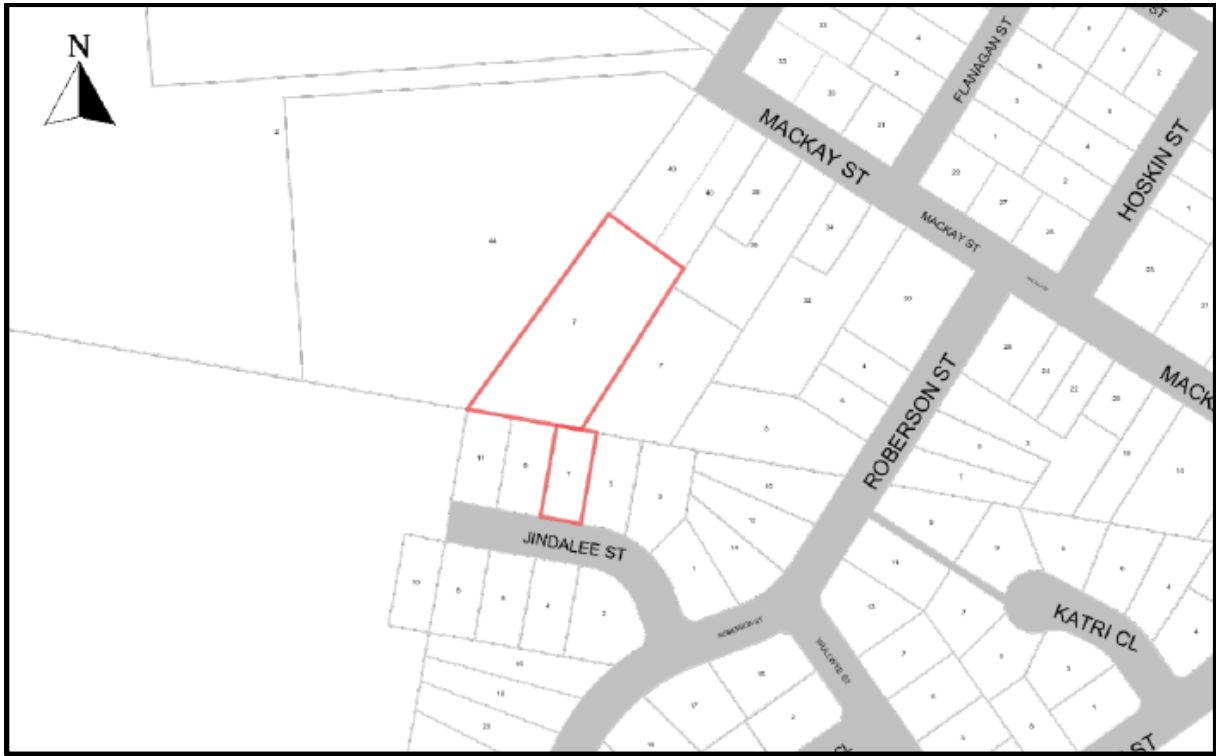

**Appendix 2 Satellite imagery with site location highlighted**

